

combiloop CL1 G

THE PERFECT MATCH WITH YOUR TOOLING MACHINE 完美匹配您的加工机器



The most compact unit of the combiloop family! As well as its larger siblings, is characterized by the new filter concept. Which brings a tripling of the filter surface with theme. In combination with the extremely compact design is machine unique in its class in terms of efficiency and performance. The perfect entry in the world of high pressure.

combiloop 系列最为紧凑的装置! 和其同系列更大型的装置一样, 以采用全新过滤理念为特色。由此将过滤表面提升至三倍。与极为紧凑的设计相结合, 实现效率和性能上与同类相比最佳的机器。高压领域的完美入门产品。

Technical data // 技术数据

Equipment	// Approx. 500 x 400 x 680 mm (L x W x H), weight approx. 120 kg // 70 bar, high-pressure pump as constant pump (robust gear pump) // Power supply 3~ / PE 400 V / 50 Hz
Flow rate	9 / 12 / 16 / 20 l/min
Pressure	Progressive up to 70 bar
Filter	Exchangeable filter, mesh washable
Filter fineness	40 µm, 60 µm
Operation	// Cutting oil // Water emulsion (min. 8 % oil content)
Service connections	Up to 4 controllable service connections
Degree of machine contamination	Low degree of machine contamination (e.g. free cutting steel, rough chips, just few fine chips)

设备	// 大约 500 x 400 x 680 mm (长 x 宽 x 高), 重量大约 120 kg // 70 bar, 恒定压力的高压泵 (高性能的齿轮泵) // 电源 3~ / PE 400 V / 50 Hz
流速	9 / 12 / 16 / 20 l/min
压力	最高渐进至 70 bar
过滤器	可替换过滤器, 可清洗过滤网
过滤精度	40 µm, 60 µm
工作	// 切削油 // 切削液 (至少含 8 % 乳化液)
服务接口	最多 4 个可控制的服务接口
机器污染程度	低机器污染度 (例如易切削钢, 粗切屑, 仅少量细切屑)

Benefits

- // A large number of machining operations requiring high pressures can be mapped in an area between 50 and 70 bar.
- // New development: Triple filter area for higher medium purity and longer filter service life.
- // Fast and simple filter changes: Thanks to quick release filter change system.

优势

- // 大量需要高压的加工操作处于50到 70 bar 的范围内。
- // 新开发: 三倍过滤面积, 实现更高介质纯度和更长的过滤器使用寿命。
- // 快捷更换过滤器: 采用快速释放过滤器更换系统。

combiloop CL1 G

THE PERFECT MATCH WITH YOUR TOOLING MACHINE 完美匹配您的加工机器

Function // 功能

- // High pressure: up to 70 bar
- // Flow rate: up to 20 l/min
- // 高压: 最高 70 bar
- // 流速: 最高 20 l/min



Experience one core-innovation
behind our compactness –
our ingenious filtration!
体验我们紧凑性背后的核心创新 –
我们独创性的过滤!

- 1 // Mobile high-pressure unit in an aesthetic design
- 2 // Control valve with pressure gauge for smooth adjustment of the operating pressure
- 3 // Fine filter as exchangeable filter
- 4 // Manifold with controllable service connections (option)
- 5 // Electronic control (option, not visible)
- 6 // High-pressure pump as constant pump (gear pump)
- 7 // Contamination indicator (option)

Fields of application:

Breaking chips early, spindle flushing, deep hole drilling of up to 2.5 mm and 10xD at 70 bar at the use of gun drills.

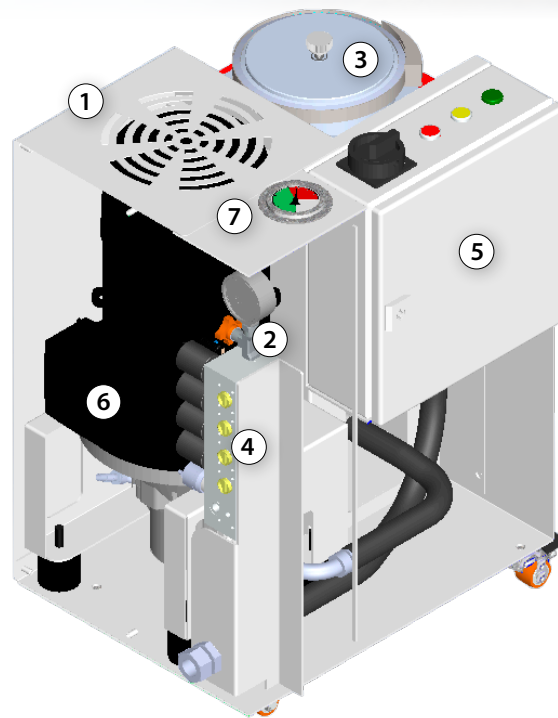

- 1 // 采用美观设计的移动高压装置
- 2 // 带压力表的控制阀, 可平稳调节工作压力
- 3 // 作为可替换式过滤器的精细过滤器
- 4 // 多种可控服务接口 (可选)
- 5 // 电子控件 (选件, 不可见)
- 6 // 恒定压力的高压泵 (高性能的齿轮泵)
- 7 // 污染程度显示 (可选)

应用领域:

提前分解碎屑, 主轴冲洗, 在深孔钻方面, 70 bar 压下, 2.5 mm 直径枪钻可达到 10xD mm 深度。

Your notes: // 您的注释:

M-Tech Machinery (Kunshan) Co., Ltd.
by MÜLLER HYDRAULIK GmbH
German Industrial Park II
No. 329, Jujin Road, Zhangpu Town
215321 Kunshan, P.R. China

穆泰克机械 (昆山) 有限公司
隶属 by MÜLLER HYDRAULIK GmbH
中国江苏省昆山市张浦镇
俱进路 329 号
邮编 215321



müller
efficiency matters